

# FOR LEASE

2400 Lake Shore Drive, Woodstock, IL 60098

## PROPERTY HIGHLIGHTS



### PROPERTY SPECIFICATIONS

**OFFERING :** +/- 4,400 SF Office Condo

**LEASE:** \$15 SF NNN

**CAM :  
& Taxes** \$4.80 SF

**SIZE:** 4,400 SF

**AGE:** 2006

**BASEMENT:** NO

**ZONING:** B3 (City of Woodstock)

**WATER & :  
SANITARY** Municipal

**PARKING:** Shared Lot

**SIGNAGE:** Monument Signage

**TRAFFIC:  
COUNTS** 16,200 VPD | US Hwy 14

**R.E. TAXES:** \$25, 269 (2023)

### Property Highlights

- Office Condominium Available For Lease
- Fully Built Out | Ideal for Professional Offices / Services
- 4,400 SF Available For Lease : Includes Private Offices, Reception / Waiting Area, Open Work Space, Conference Room, Kitchenette Break Room and Restrooms
  - Ample Amount of Parking with Shared Lot in Front and Back of Building
- Affluent Population with Average Household Income Exceeding \$96,655 Within 3 Mile Radius | 16,200 VPD on US Hwy14

Offered By:  
Tim Billimack | Nicole Kirchberg  
815.355.0196 | 815-307-2222  
billimackt@gmail.com  
nckirchberg@gmail.com

Blue Chip Commercial Real Estate, LLC, 101 N. Main Street, Unit 15, Crystal Lake, IL 60014  
[www.bluechipcommercialre.com](http://www.bluechipcommercialre.com)



# FOR LEASE

2400 Lake Shore Drive, Woodstock, IL 60098

*Floorplan*

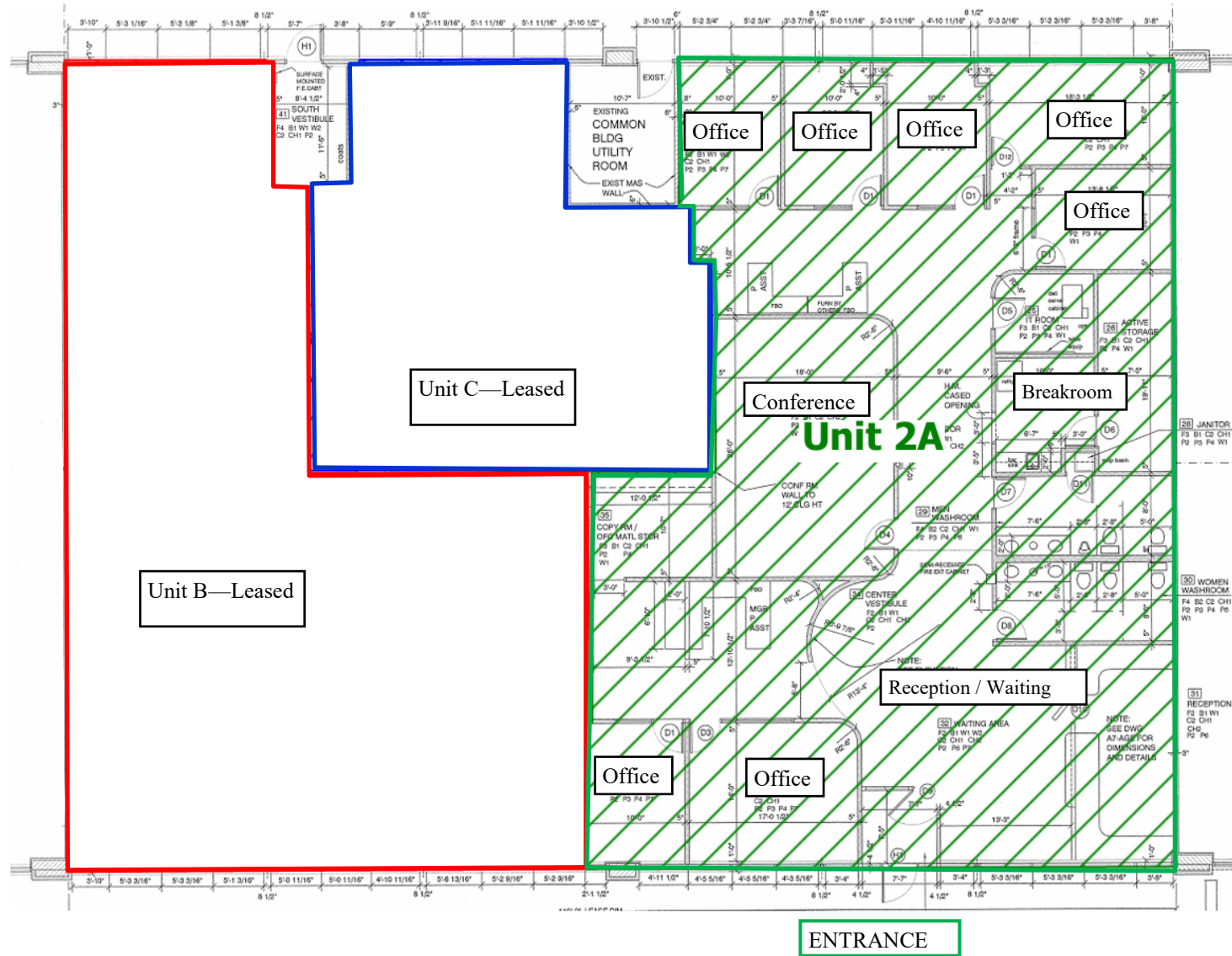



# FOR LEASE

2400 Lake Shore Drive, Woodstock, IL 60098

*AERIAL*



Blue Chip Commercial Real Estate, LLC, 101 N. Main Street, Unit 15, Crystal Lake, IL 60014  
[www.bluechipcommercialre.com](http://www.bluechipcommercialre.com)





# FOR LEASE

2400 Lake Shore Drive, Woodstock, IL 60098

*PHOTOS*



Blue Chip Commercial Real Estate, LLC, 101 N. Main Street, Unit 15, Crystal Lake, IL 60014  
[www.bluechipcommercialre.com](http://www.bluechipcommercialre.com)



# FOR LEASE

2400 Lake Shore Drive, Woodstock, IL 60098

## MAP & DEMOGRAPHICS

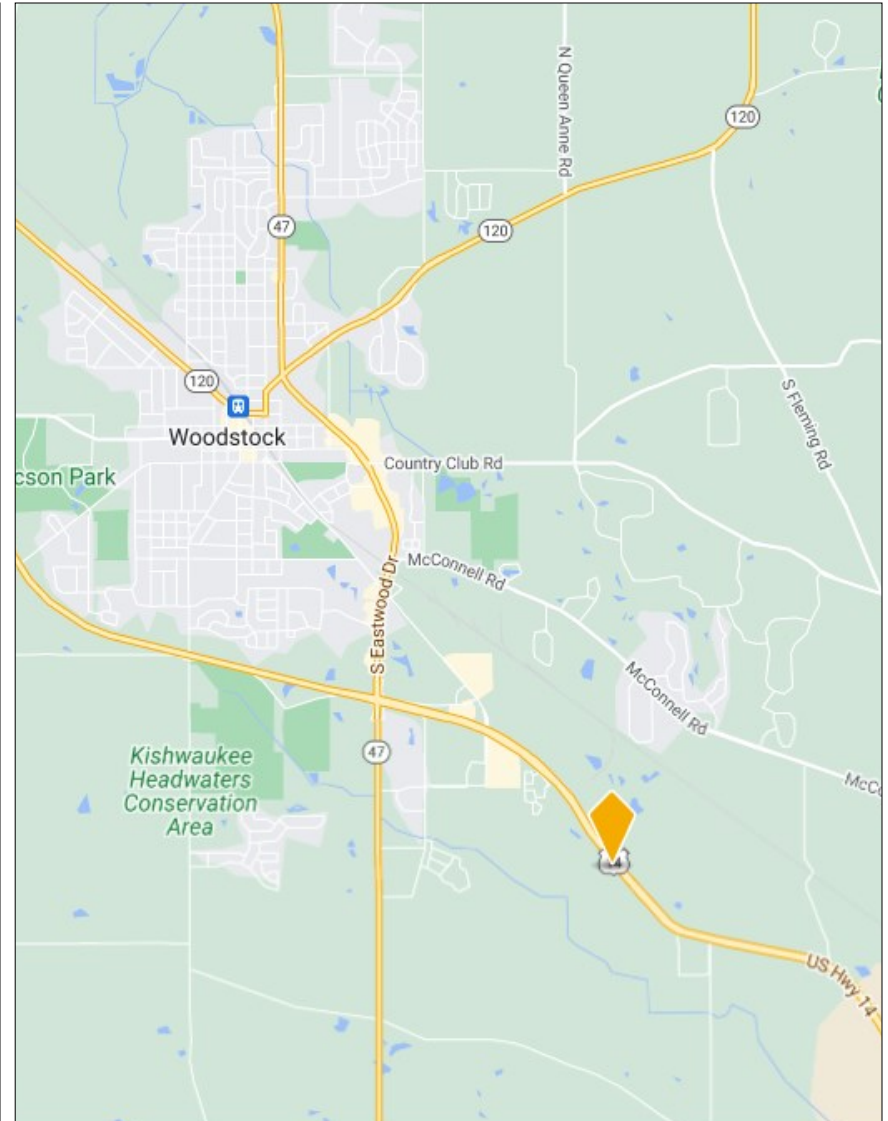
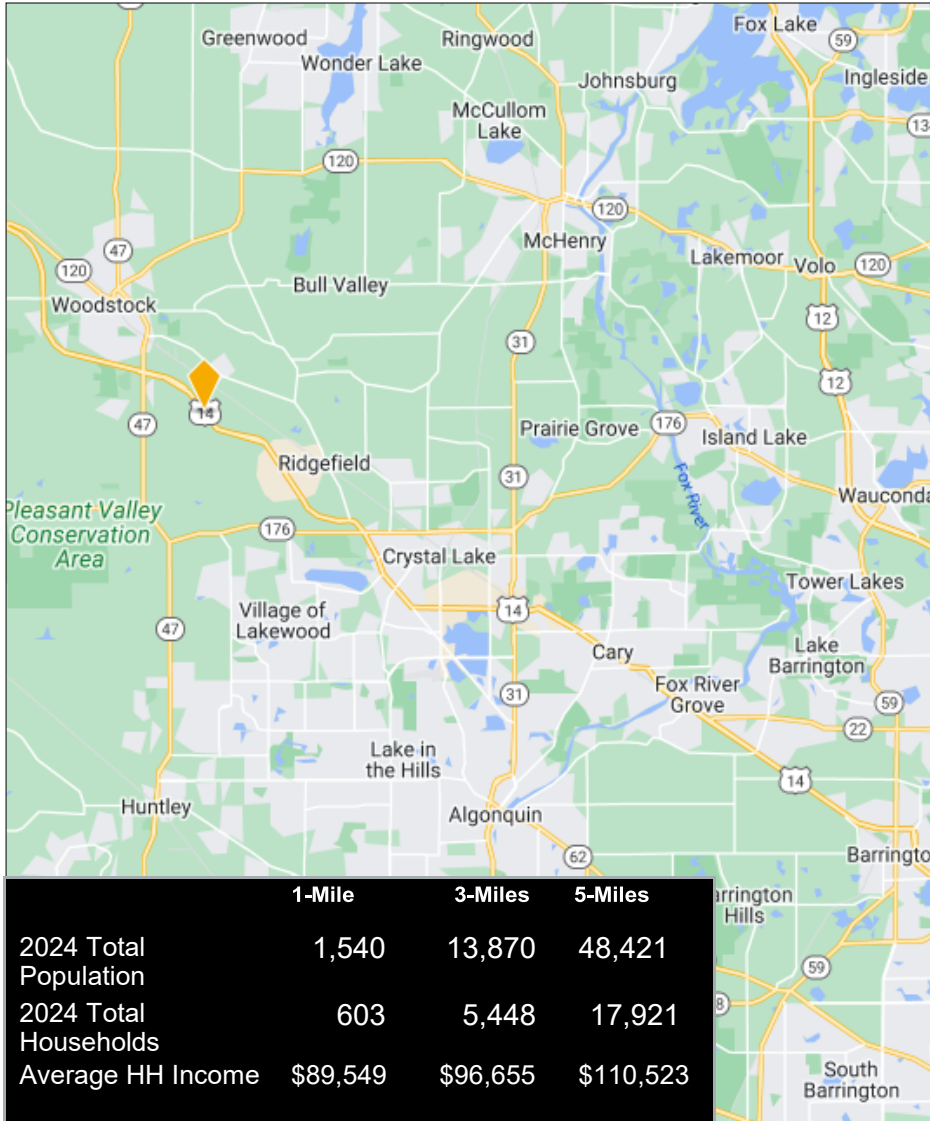

Disclaimer: Blue Chip Commercial Real Estate, LLC is the owner's designated agent and makes no warranties or representations as to the accuracy or completeness of this information contained herein. The information has been obtained through sources deemed reliable; however, it is up to the purchaser to conduct due diligence prior to sale or lease.